



2017 Fall HERITAGERAIL ALLIANCE Conference
Hosted by the Minnesota Streetcar Museum
Minneapolis, Minnesota
October 4 to 7, 2017



VENDOR REGISTRATION - HRA MEMBER

HERITAGERAIL ALLIANCE * c/o HRA/ATRRM 2017 Fall Conference * P.O. Box 1189 * Covington, GA 30015
 Please print and return this registration packet and full payment to the address above. **Please make checks payable to ATRRM.** Refunds less a \$50.00 administrative fee will be made before **September 1**. No refunds will be made beginning **September 2**. Registration price includes person and **one table**, all seminars, receptions, Thursday and Friday breakfasts, conference field trips and Saturday banquet.

GENERAL VENDOR INFORMATION - \$450, includes reserved table and one conference registration):

NOTE: Registration fee is \$550 after September 1.

ORGANIZATION: _____

LEAD ATTENDEE: _____

MAILING ADDRESS: _____

CITY: _____ **STATE:** _____ **ZIP:** _____

PHONE: _____ **E-MAIL:** _____

PRIMARY CONTACT: _____

EMERGENCY CONTACT: _____

Extra tables @ \$150 each _____

ADDITIONAL ATTENDEES - \$300 per person (\$400 after September 1)

Name and Title: _____

Name and Title: _____

Total Registration fee:

Vendor space \$ _____

Extra tables \$ _____

Additional attendees \$ _____

TOTAL PAYMENT: \$ _____

(Record this amount on line #1 in the payment summary on page 3)

IN NEED OF SPECIAL ACCOMMODATION COVERED UNDER ADA? IF SO, PLEASE DESCRIBE:

PRE-CONFERENCE TRIPS

Tuesday, October 3

Railfan All-day Tour of the Twin Cities

\$ 75.00 per person (limited to 55 passengers)

We'll spend the day visiting Twin City rail attractions not included in the rest of the conference. Sites visited include BNSF's Northtown yard, Soo Lines' Shoreham yard, the Minnesota Commercial RR roundhouse, Westminster Junction, Dayton's Bluff & BNSF's Pig's Eye Yard, Newport Tower, Milwaukee Road depot and the Northstar commuter rail station. The trip includes a ride on the Northstar Commuter Rail line at the end of the tour.

Total Number of passengers: _____ **Total:** \$ _____

Wednesday – October 4

Trip to Duluth, Minn to Lake Superior Railroad Museum and ride on the North Shore Scenic Railroad.

\$ 100.00 per person (Limited to 110 passengers)

We depart the hotel at 7:00 AM and after a two and a half hour motor coach ride to Duluth we'll catch the steam-powered North Shore Scenic Railroad train to Two Harbors. We'll enjoy a box lunch on the train to Two Harbors where we'll visit the Duluth, Missabe & Northern depot, the giant Duluth, Missabe & Iron Range Yellowstone 2-6+6-4 locomotive and a 2-6-0 on display adjacent to the depot. Upon our return to Duluth we'll tour the Lake Superior Railroad Museum and enjoy the displays and a first class collection of rolling stock including the first Great Northern and Northern Pacific steam locomotives. Enroute to Minneapolis we'll visit the Hinckley Fire Museum, returning to the hotel by 6:00 PM.

Total Number of passengers: _____ **Total:** \$ _____

Wednesday – October 4

Traction/Trolley Highlights Tour of the Twin Cities

\$ 50.00 per person (Limited to 45 passengers)

On this trip we'll visit remnants of buildings, structures and artifacts remaining from the days of the Twin City Rapid Transit Company's streetcar era. We'll be riding on a vintage GM 5105 transit bus, the vehicle that replaced the Twin City Lines streetcars starting in the early 1950s. We'll have Lunch at the St. Paul Union Depot (SPUD) and then take a Green Line light rail train back to Minneapolis where we'll re-join the bus for the quick ride to the Minnesota Streetcar Museum's Como-Harriet Streetcar Line demonstration railway in southwest Minneapolis. The visit to Como-Harriet will include tours of the carbarn and shop, the Linden Hills station, discussions with MSM's shop workers, and guest operations for the remainder of the afternoon.

Total Number of passengers: _____ **Total \$:** _____

TOTAL PRE-CONFERENCE TRIPS: \$ _____

(Record this amount on line #2 in the payment summary on page 3)

SPOUSE/TRAVEL COMPANION OPTIONS

Thursday, Friday and Saturday – October 5-7

Spouse/Travel Companion Program

\$ 100.00 per person

See the Twin Cities during this 3-day program. We'll visit the Mississippi riverfront, including St. Anthony Falls and the Stone Arch Bridge, and learn how Minneapolis got its name at the Mill City Museum. The Minneapolis Institute of Arts is the biggest art museum in the Twin Cities. In St. Paul we'll tour the new restored Minnesota State capitol, the historic James J. Hill House and the monumental St. Paul Union Depot. On Friday we travel to the quaint suburb of Excelsior for shopping and a steamboat cruise on Lake Minnetonka. Plus there's the Mall of America with 500+ stores, Minnehaha Falls Park and fine eateries.

Number of persons: _____ **Total \$:** _____

(Record this amount on line #3 in the payment summary on this page)

Saturday – October 7

Banquet--additional attendees

\$ 75.00 per person (this applies only to non-conference attendees)

Additional banquet guests: _____ **Total \$:** _____

(Record this amount on line #4 in the payment summary on this page)

Payment Summary

Basic Registration(s) and table(s)	\$ _____
	Line #1
Pre-conference trips	\$ _____
	Line #2
Spouse/Travel Companion Program	\$ _____
	Line #3
Additional Banquet Guests	\$ _____
	Line #4
TOTAL	\$ _____

Saturday Banquet Choices:

Primary Registrant: ___Chicken ___Salmon ___Steak ___Vegetarian

Additional Attendee #1: ___Chicken ___Salmon ___Steak ___Vegetarian

Additional Attendee #2: ___Chicken ___Salmon ___Steak ___Vegetarian

Additional Attendee #3: ___Chicken ___Salmon ___Steak ___Vegetarian

Spouse/Travel Companion: ___Chicken ___Salmon ___Steak ___Vegetarian

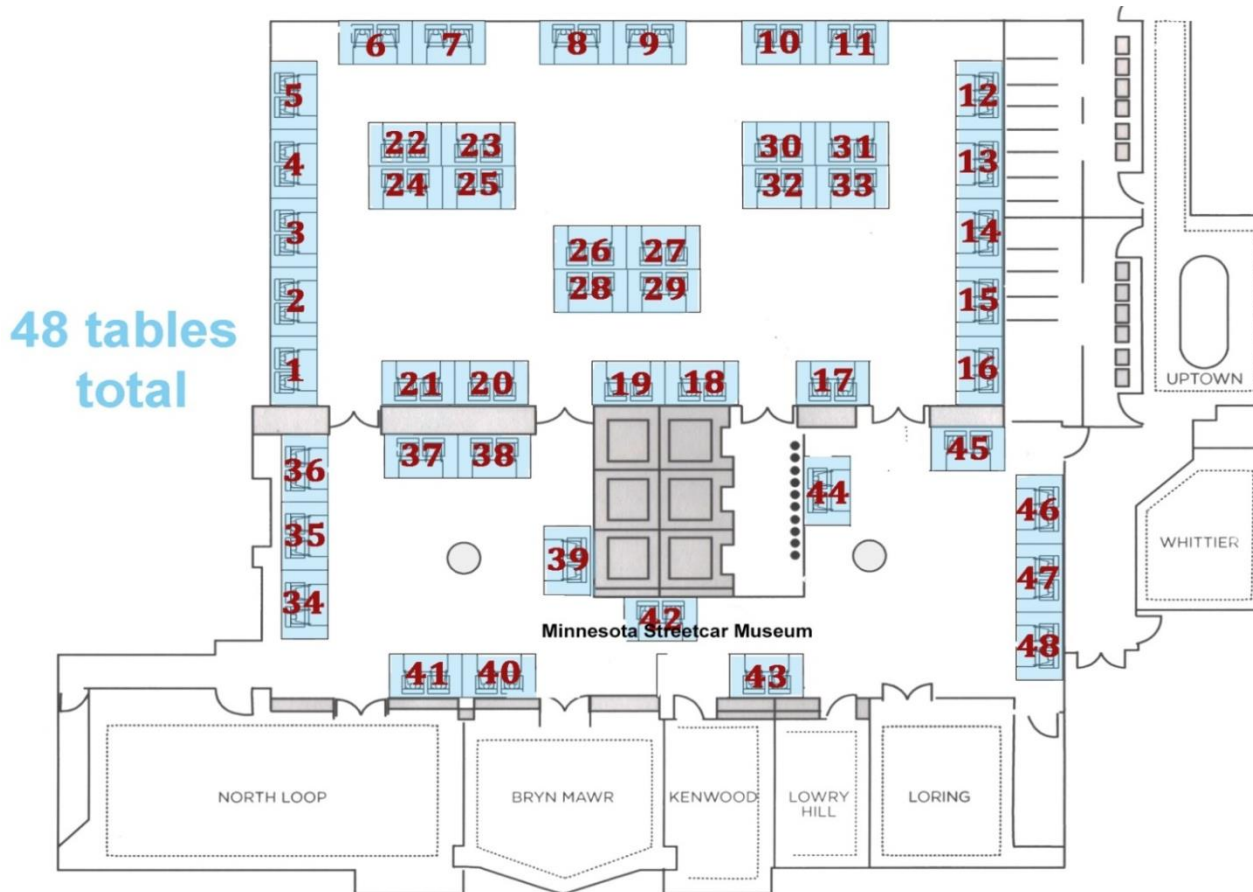

VENDOR NAME: _____

First Table Choice _____ Second Table Choice _____ Third Table Choice _____

Vendor space for the 2017 Fall Conference is being offered in the main ballroom area on the fourth floor of the Loew's Minneapolis hotel (as shown in the above diagram) and in the lobby adjacent to the seminar rooms. Table selections will be issued on a first-request, first-reserved basis. Please indicate your top three choices above.

Breakfasts and morning refreshments on Thursday and Friday will be served in the main vendor display room and in the seminar room lobby.

IMPORTANT!

Please e-mail a high resolution image of your logo to Aaron Isaacs, 2017 HRA/ATTRM Fall Conference Chair, before **September 1, 2017**. E-mail: aaronmona@aol.com

Vendor tables are standard six-foot by 30 inches in size. Tables will have cloth around the tables and electric outlets and drop-cords will be available.

TABLE/DISPLAY SET-UP: Displays set up is **Wednesday, October 4 no earlier than 3:00 PM.**

TABLE/DISPLAY REMOVAL: Tables must be cleared and displays removed from the display area **no later than 4:00 PM on Friday, October 6.**